

General Features

- ▶ High corrosion resistant performance: Pb-Ca multi-alloy grid
- ▶ High energy density and power density
- ▶ Optimized capability of instant high-current discharging
- ▶ Excellent charge acceptance ability
- ▶ Excellent deep cycle discharge capability
- ▶ Strong high and low temperature performance
- ▶ Precision sealing technology
- ▶ Long life



Dimension: 520(L) × 268(W) × 220(H) × 223(TH)

Unit: mm

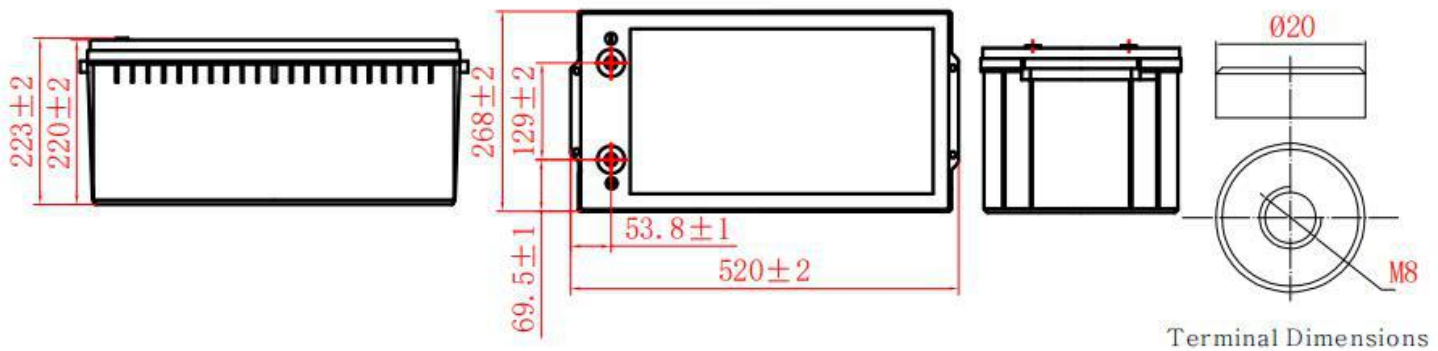

Specification	
Nominal Voltage	12V
Nominal Capacity	250Ah
Design life	10 years
Terminal	M8
Approx. Weight	Approx 71.0kg (157lbs)
Container Material	ABS
short-circuit current	3157A
Internal resistance(Full charged at 25°C:)	3.8 mΩ
Self discharge	3% of capacity declined per month at 25°C
Operating Temperature	
Discharge:	-20 ~50°C(-4~ 122°F)
Charge :	-20 ~50°C(-4~ 122°F)
Storage:	-20 ~50°C(-4~ 122°F)
Charge Method(25 °C)	
Charge current:	Max. 62.5A; Recom. 25A
Float charge: 13.5-13.8V	recom. 13.8V(-18mV/ °C)
Equalize charge: 13.8-14.1V	recom. 14.1V(-24mV/ °C)
Cycle charge: 14.4-15.0V	recom. 14.7V(-30mV/ °C)

Standards

Executive standard YD/T 799-2010

Applications

- ▶ UPS/EPS
- ▶ Power systems
- ▶ Telecommunications system
- ▶ Emergency lighting, Auto control system
- ▶ Solar/wind generating storage cyclic
- ▶ Other general purpose

Rated Capacity

10Hour Rate (25.0A to 10.8V)	250.0Ah
3Hour Rate (68.4A to 10.2V)	205.2Ah
1Hour Rate (168A to 9.6V)	168.0Ah

Attain Certificate



Discharge characteristic

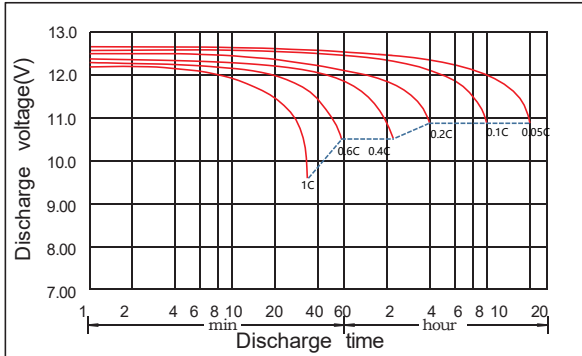

Charging characteristic

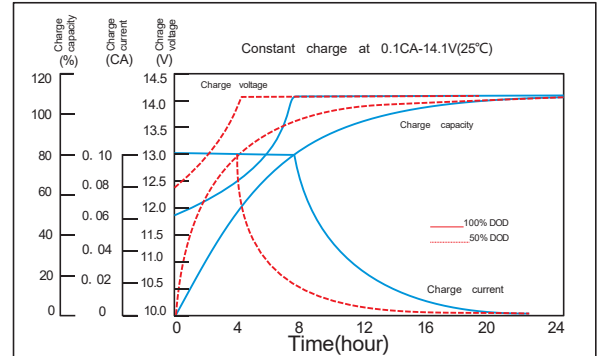

The effect of temperature on capacity

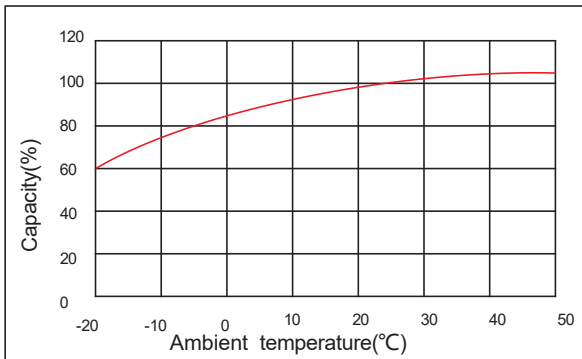

The effect of temperature on float life

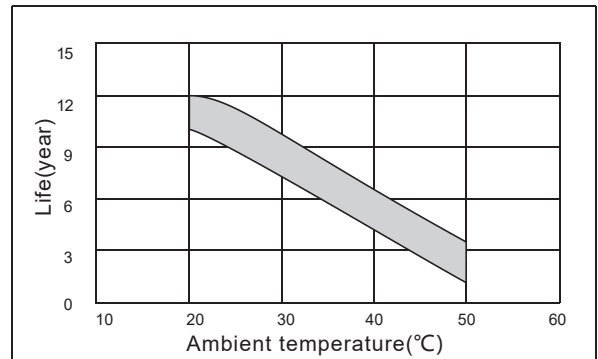

Constant Current Discharge Characteristics Unit:A (25°C,77°F)

FV/Time	5min	10min	15min	30min	45min	1h	1.5h	2h	3h	4h	5h	6h	8h	10h	20h
1.60V	306	306	306	230	199	168	106	96.5	70.1	50.7	47.0	37.5	30.9	26.0	13.7
1.65V	301	301	301	226	197	167	105	96.0	69.3	50.3	46.6	37.2	30.6	25.8	13.6
1.70V	289	289	289	222	194	166	104	95.3	68.4	49.7	46.1	36.8	30.4	25.5	13.5
1.75V	266	266	266	220	192	164	103	93.8	67.6	49.3	45.6	36.5	30.1	25.3	13.5
1.80V	238	238	238	211	185	159	102	92.1	67.1	48.8	44.3	36.0	29.9	25.0	13.4
1.85V	212	212	212	192	170	148	98.8	87.5	63.2	47.4	42.1	35.0	28.7	24.3	13.2

Constant Power Discharge Characteristics Unit: W/cell (25°C ,77°F)

FV/Time	5min	10min	15min	30min	45min	1h	1.5h	2h	3h	4h	5h	6h	8h	10h	20h
1.60V	520	520	520	451	390	330	209	190	138	99.9	92.6	73.9	61.2	51.5	27.0
1.65V	512	512	512	443	385	328	207	189	137	99.1	91.8	73.3	60.6	51.1	26.9
1.70V	491	491	491	435	380	326	205	188	135	97.9	90.8	72.5	60.2	50.5	26.8
1.75V	452	452	452	432	377	322	203	185	133	97.1	89.8	71.9	59.6	50.1	26.6
1.80V	404	404	404	413	362	313	201	181	132	96.1	87.3	70.9	59.2	49.5	26.5
1.85V	363	363	363	379	335	293	196	173	125	93.9	83.4	69.3	57.1	48.4	26.3