

General Features

- ▶ High corrosion resistant performance: Pb-Ca multi-alloy grid
- ▶ High energy density and power density
- ▶ Optimized capability of instant high-current discharging
- ▶ Excellent charge acceptance ability
- ▶ Excellent deep cycle discharge capability
- ▶ Strong high and low temperature performance
- ▶ Precision sealing technology
- ▶ Long life



Dimension: 330(L) × 171(W) × 216(H) × 219(TH)

Unit: mm

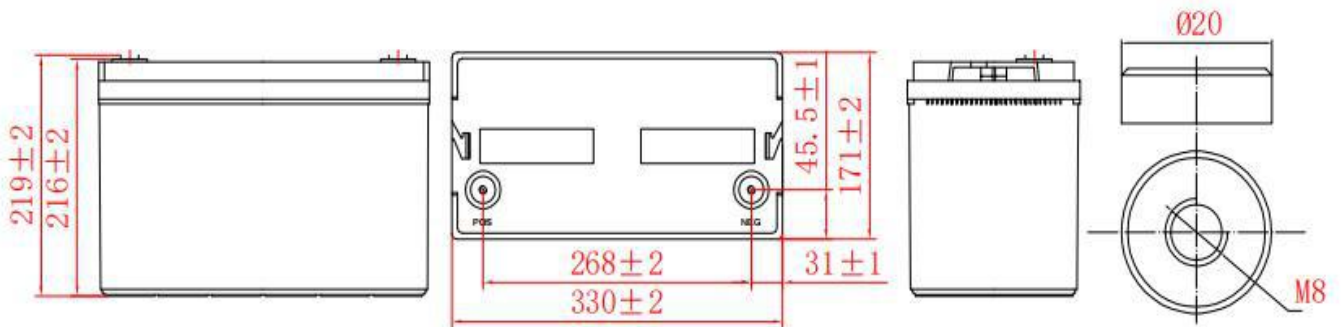

Terminal Dimensions

Specification	
Nominal Voltage	12V
Nominal Capacity	95Ah
Design life	10 years
Terminal	M8
Approx. Weight	Approx. 28.0kg (61.7lbs)
Container Material	ABS
short-circuit current	2181A
Internal resistance (Full charged at 25°C:)	5.5 mΩ
Self discharge	3% of capacity declined per month at 25°C
Operating Temperature	
Discharge:	-20 ~ 50°C (-4 ~ 122°F)
Charge :	-20 ~ 50°C (-4 ~ 122°F)
Storage:	-20 ~ 50°C (-4 ~ 122°F)
Charge Method (25 °C)	
Charge current:	Max. 23.75A; Recom. 9.5A
Float charge: 13.5-13.8V	recom. 13.8V (-18mV/ °C)
Equalize charge: 13.8-14.1V	recom. 14.1V (-24mV/ °C)
Cycle charge: 14.4-15.0V	recom. 14.7V (-30mV/ °C)

Standards

Executive standard YD/T 799-2010

Applications

- ▶ UPS/EPS
- ▶ Power systems
- ▶ Telecommunications system
- ▶ Emergency lighting, Auto control system
- ▶ Solar/wind generating storage cyclic
- ▶ Other general purpose

Rated Capacity

10Hour Rate (9.50A to 10.8V)	95.0Ah
3Hour Rate (26.1A to 10.2V)	78.3Ah
1Hour Rate (64.3A to 9.6V)	64.3Ah

Attain Certificate

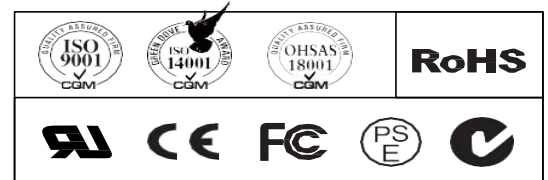



JM Series lead-acid battery JM12-100

Discharge characteristic

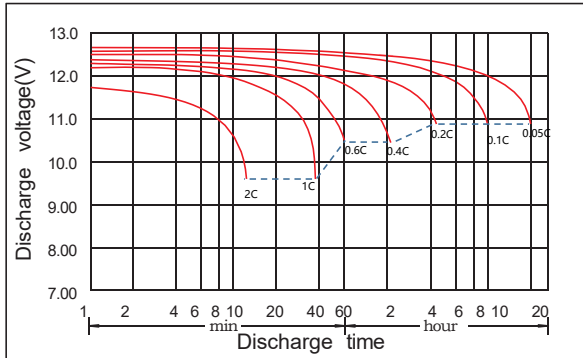

Charging characteristic

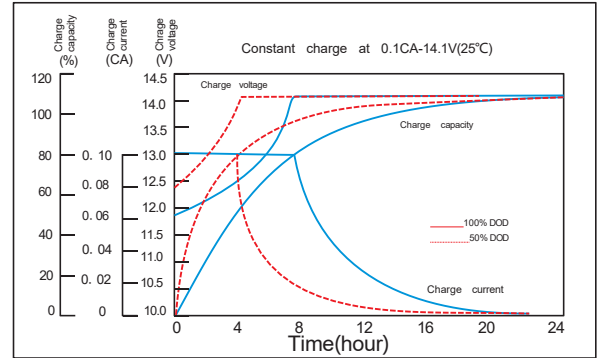

The effect of temperature on capacity



The effect of temperature on float life

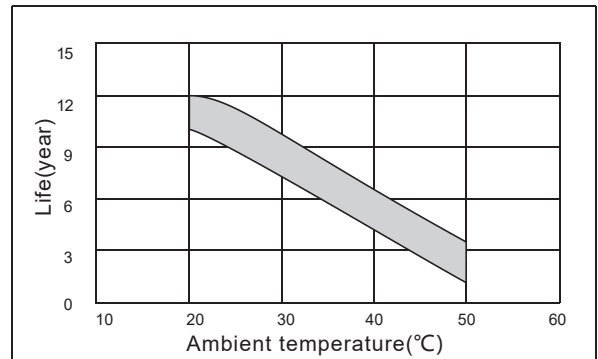

Constant Current Discharge Characteristics Unit:A (25°C,77°F)

FV/Time	5min	10min	15min	30min	45min	1h	1.5h	2h	3h	4h	5h	6h	8h	10h	20h
1.60V	276	224	171	111	78.9	64.3	40.6	36.9	26.8	19.5	18.0	14.3	11.8	9.98	5.22
1.65V	268	218	167	109	78.5	63.9	40.2	36.7	26.5	19.3	17.8	14.2	11.7	9.88	5.19
1.70V	257	210	163	107	77.8	63.5	39.8	36.4	26.1	19.1	17.6	14.1	11.6	9.79	5.16
1.75V	237	197	158	106	76.7	62.5	39.4	35.8	25.8	18.9	17.4	14.0	11.5	9.69	5.14
1.80V	212	179	147	101	74.7	60.9	38.7	35.2	25.7	18.5	16.9	13.7	11.4	9.50	5.11
1.85V	189	160	131	92.6	69.3	56.4	37.7	33.4	24.1	18.1	16.1	13.4	10.9	9.26	5.03

Constant Power Discharge Characteristics Unit: W/cell (25°C ,77°F)

FV/Time	5min	10min	15min	30min	45min	1h	1.5h	2h	3h	4h	5h	6h	8h	10h	20h
1.60V	463	379	302	201	146	122	80.9	69.7	50.9	38.2	34.1	28.0	22.9	19.1	10.4
1.65V	446	367	298	199	144	121	79.8	69.5	50.3	37.8	33.9	27.6	22.7	18.9	10.3
1.70V	443	355	293	199	143	120	78.9	69.3	50.0	37.4	33.6	27.5	22.6	18.7	10.3
1.75V	413	335	292	198	143	119	78.2	68.9	49.7	37.1	33.4	27.2	22.4	18.5	10.2
1.80V	380	310	276	194	142	118	77.3	68.7	49.5	36.7	33.1	26.9	22.2	18.3	10.2
1.85V	339	279	247	177	131	109	76.2	65.6	47.0	36.1	31.5	26.5	21.5	18.1	10.1