



JLG Series Pure GEL battery JLG6-210

General Features

- ▶ Nanosilica colloidal electrolyte and high tin positive plate alloy design to enhance battery performance
- ▶ Relatively rich electrolyte, high temperature and low temperature performance is superior
- ▶ Long cycle life, excellent deep cycle discharge ability
- ▶ Excellent charge acceptance ability
- ▶ Precision sealing technology
- ▶ Long life



Dimension: 243(L) × 188(W) × 275(H) × 275(TH)

Unit: mm

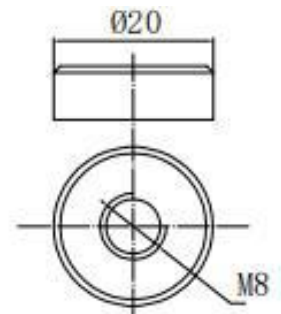
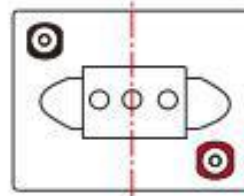
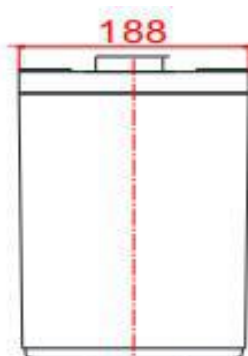
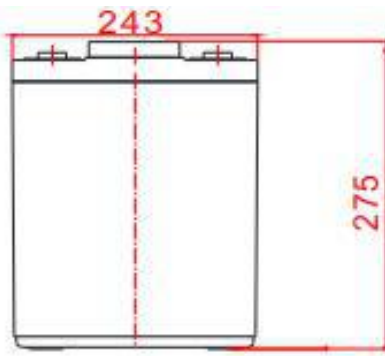

Terminal Dimensions

Specification	
Nominal Voltage	6V
Nominal Capacity	210Ah
Design life	10 years
Terminal	M8
Approx. Weight	Approx 29.5kg (65.0lbs)
Container Material	ABS
short-circuit current	1764A
Internal resistance(Full charged at 25°C:)	3.4 mΩ
Self discharge	3% of capacity declined per month at 25°C
Operating Temperature	
Discharge:	-40 ~60°C(-40~ 140°F)
Charge :	-20 ~50°C(-4~ 122°F)
Storage:	-20 ~50°C(-4~ 122°F)
Charge Method(25 °C)	
Charge current:	Max. 52.5A; Recom. 21.0A
Float charge:	6.75-6.90V recom. 6.90V(-9mV/ °C)
Equalize charge:	6.90-7.05V recom. 7.05V(-12mV/ °C)
Cycle charge:	7.20-7.50V recom. 7.35V(-15mV/ °C)

Applications

- ▶ UPS/EPS
- ▶ Power systems
- ▶ Telecommunications system
- ▶ Emergency lighting, Auto control system
- ▶ Solar / wind energy and other new energy storage
- ▶ Other general purpose

Rated Capacity

20Hour Rate (10.5A to 5.25V)	210.0Ah
3Hour Rate (52.5A to 5.10V)	157.5Ah
1Hour Rate (116A to 4.80V)	116.0Ah

Attain Certificate



Disclaimer: Manufacturers have the right to self-modify the parameters of the product updates, please keep in touch with manufacturers to obtain the latest information.

Discharge characteristic

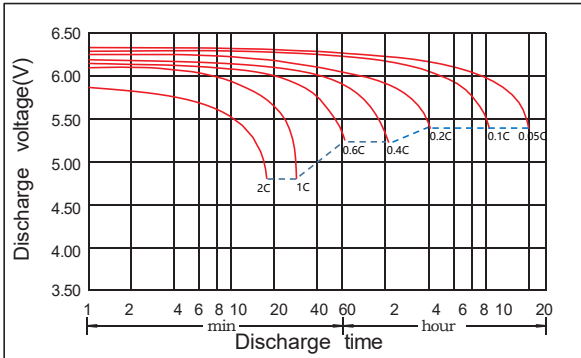

Charging characteristic

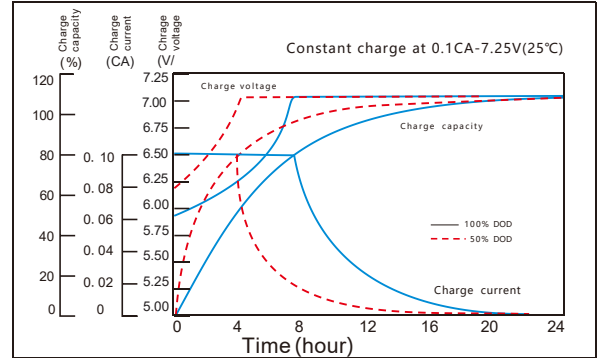

The effect of temperature on capacity

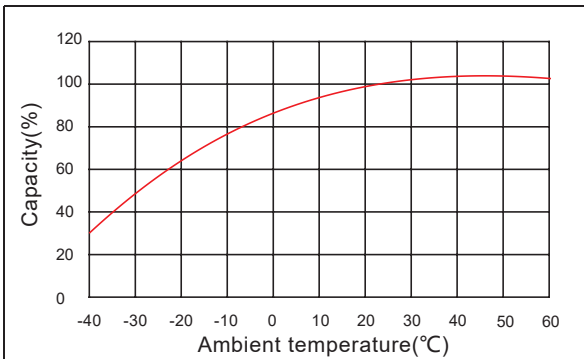

Curves of open circuit voltage vs. capacity

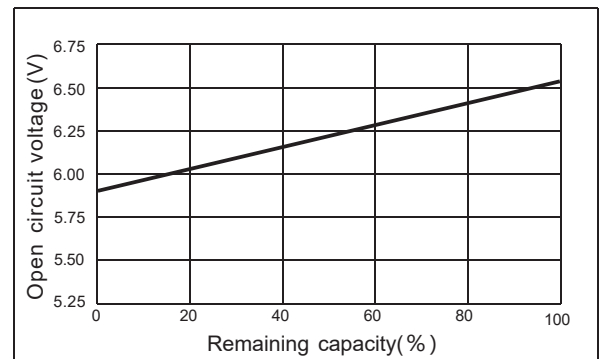

Constant Current Discharge Characteristics Unit:A (25°C,77°F)

FV/Time	30min	1h	2h	3h	5h	8h	10h	20h
1.60V	200	116	66.6	53.8	36.1	23.4	19.8	10.8
1.65V	196	115	66.2	53.4	35.9	23.2	19.6	10.7
1.70V	192	114	65.7	52.5	35.4	23.0	19.4	10.6
1.75V	191	113	64.7	51.9	35.0	22.8	19.2	10.5
1.80V	183	110	63.6	51.6	34.1	22.7	19.0	10.4
1.85V	167	102	60.3	48.7	32.4	21.7	18.4	10.3

Constant Power Discharge Characteristics Unit: W/cell (25°C,77°F)

FV/Time	30min	1h	2h	3h	5h	8h	10h	20h
1.60V	362	220	127	103	68.5	45.6	38.0	21.1
1.65V	359	218	126	102	68.1	45.2	37.6	21.0
1.70V	358	216	125	101	67.7	45.0	37.2	20.9
1.75V	356	214	124	100	67.2	44.8	36.9	20.8
1.80V	346	213	123	99.8	66.4	44.1	36.5	20.7
1.85V	317	197	118	94.8	63.4	42.9	35.9	20.5