



JLG Series Pure GEL battery JLG12-50

General Features

- ▶ Nanosilica colloidal electrolyte and high tin positive plate alloy design to enhance battery performance
- ▶ Relatively rich electrolyte, high temperature and low temperature performance is superior
- ▶ Long cycle life, excellent deep cycle discharge ability
- ▶ Excellent charge acceptance ability
- ▶ Precision sealing technology
- ▶ Long life



Dimension: 229(L) × 138(W) × 205(H) × 208(TH)

Unit: mm

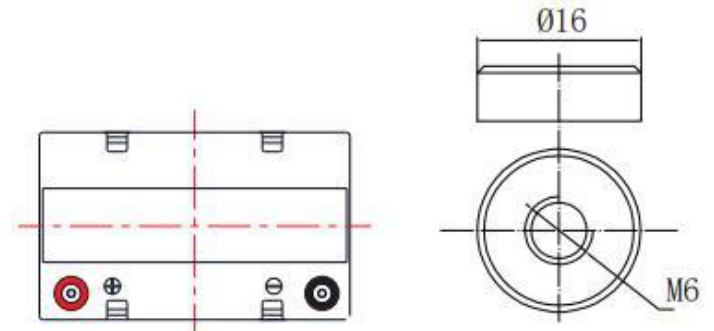
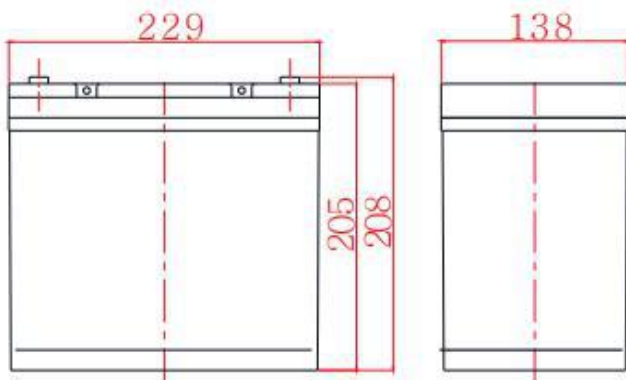

Terminal Dimensions

Specification	
Nominal Voltage	12V
Nominal Capacity	50Ah
Design life	10 years
Terminal	M6
Approx. Weight	Approx 16.3kg (35.9lbs)
Container Material	ABS
short-circuit current	888A
Internal resistance(Full charged at 25°C:)	13.5 mΩ
Self discharge	3% of capacity declined per month at 25°C
Operating Temperature	
Discharge:	-40 ~60°C(-40~ 140°F)
Charge :	-20 ~50°C(-4~ 122°F)
Storage:	-20 ~50°C(-4~ 122°F)
Charge Method(25 °C)	
Charge current:	Max. 12.5A; Recom. 5.0A
Float charge: 13.5-13.8V	recom. 13.8V(-18mV/ °C)
Equalize charge: 13.8-14.1V	recom. 14.1V(-24mV/ °C)
Cycle charge: 14.4-15.0V	recom. 14.7V(-30mV/ °C)

Applications

- ▶ UPS/EPS
- ▶ Power systems
- ▶ Telecommunications system
- ▶ Emergency lighting, Auto control system
- ▶ Solar / wind energy and other new energy storage
- ▶ Other general purpose

Rated Capacity

20Hour Rate (2.50A to 10.5V)	50.0Ah
3Hour Rate (12.5A to 10.2V)	37.5Ah
1Hour Rate (27.5A to 9.6V)	27.5Ah

Attain Certificate



Disclaimer: Manufacturers have the right to self-modify the parameters of the product updates, please keep in touch with manufacturers to obtain the latest information.

Discharge characteristic

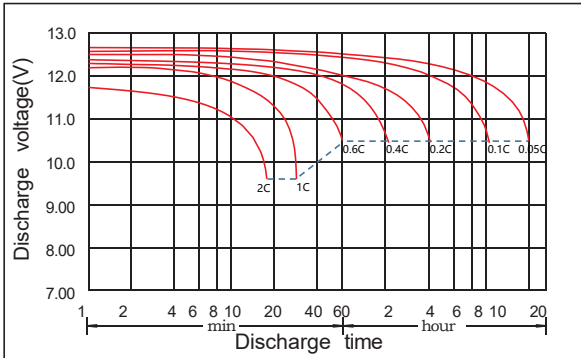

Charging characteristic



The effect of temperature on capacity

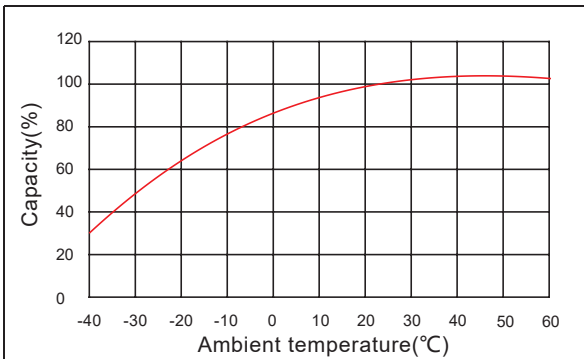

Curves of open circuit voltage vs. capacity

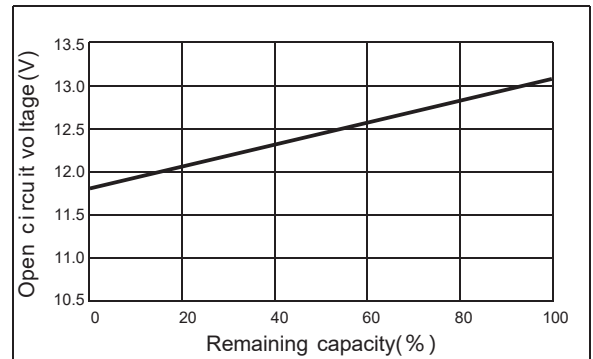

Constant Current Discharge Characteristics Unit:A (25°C,77°F)

FV/Time	30min	1h	2h	3h	5h	8h	10h	20h
1.60V	45.0	27.5	15.8	12.8	8.59	5.55	4.68	2.54
1.65V	44.1	27.3	15.7	12.7	8.54	5.50	4.64	2.53
1.70V	43.3	27.1	15.6	12.5	8.43	5.45	4.59	2.51
1.75V	42.9	26.7	15.3	12.4	8.33	5.41	4.55	2.50
1.80V	41.1	26.1	15.1	12.3	8.13	5.40	4.50	2.49
1.85V	37.5	24.1	14.3	11.6	7.72	5.15	4.37	2.44

Constant Power Discharge Characteristics Unit: W/cell (25°C,77°F)

FV/Time	30min	1h	2h	3h	5h	8h	10h	20h
1.60V	81.4	52.2	29.8	24.4	16.3	10.8	9.00	5.02
1.65V	80.7	51.7	29.7	24.1	16.2	10.7	8.90	5.00
1.70V	80.5	51.3	29.6	23.9	16.1	10.6	8.80	4.97
1.75V	80.1	50.8	29.5	23.8	16.0	10.5	8.75	4.95
1.80V	77.9	50.4	29.4	23.7	15.8	10.4	8.65	4.93
1.85V	71.4	46.7	28.0	22.6	15.1	10.3	8.50	4.88