



General Features

- ▶ High corrosion resistant performance: Pb-Ca multi-alloy grid
- ▶ Excellent charge acceptance ability
- ▶ Excellent deep cycle discharge capability
- ▶ Strong high and low temperature performance
- ▶ Precision sealing technology
- ▶ Long life



Dimension: 173(L) × 111(W) × 329(H) × 365(TH)

Unit: mm

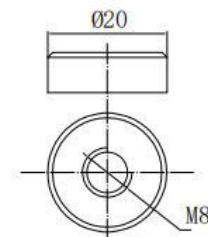
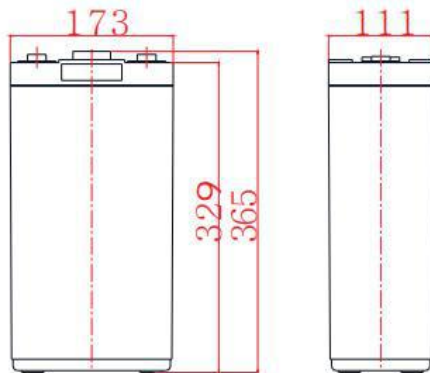

Terminal Dimensions

Specification	
Nominal Voltage	2V
Nominal Capacity	200Ah
Design life	15 years
Terminal	M8
Approx. Weight	Approx. 12.8kg (28.2lbs)
Container Material	ABS
short-circuit current	2500A
Internal resistance (Full charged at 25°C:)	0.80 mΩ
Self discharge	3% of capacity declined per month at 25°C
Operating Temperature	
Discharge:	-20 ~50°C (-4 ~ 122°F)
Charge :	-20 ~50°C (-4 ~ 122°F)
Storage:	-20 ~50°C (-4 ~ 122°F)
Charge Method (25 °C)	
Charge current:	Max. 40.0A; Recom. 20.0A
Float charge:	2.23-2.27V recom. 2.25V (-3mV/ °C)
Equalize charge:	2.30-2.35V recom. 2.35V (-4mV/ °C)
Cycle charge:	2.40-2.50V recom. 2.40V (-5mV/ °C)

Standards

Executive standard YD/T 799-2010

Applications

- ▶ UPS/EPS
- ▶ Power systems
- ▶ Telecommunications system
- ▶ Auto control system
- ▶ Solar/wind generating storage cyclic
- ▶ Other general purpose

Rated Capacity

10Hour Rate (20.0A to 1.80V)	200.0Ah
3Hour Rate (50.0A to 1.80V)	150.0Ah
1Hour Rate (110A to 1.75V)	110.0Ah

Attain Certificate



Discharge characteristic

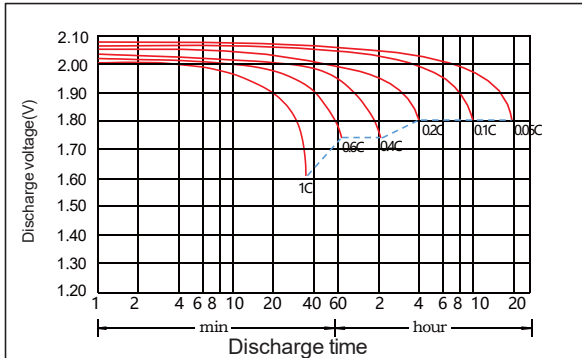

Charging characteristic

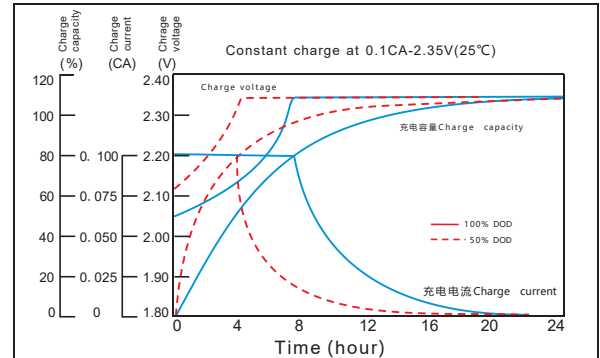

The effect of temperature on capacity

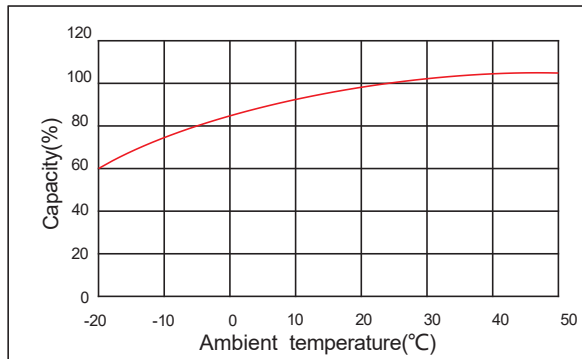

The effect of temperature on float life

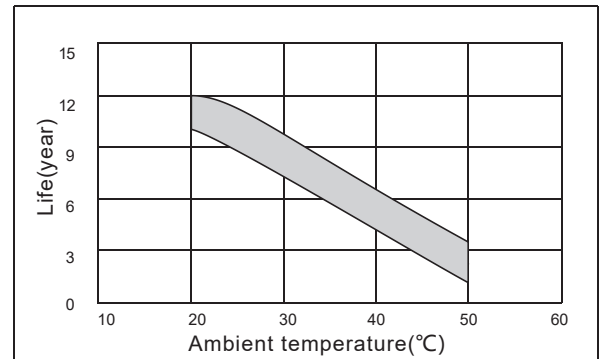

Constant Current Discharge Characteristics Unit:A (25°C,77°F)

FV/Time	5min	10min	15min	30min	45min	1h	1.5h	2h	3h	4h	5h	6h	8h	10h	20h
1.60V	353	300	250	163	139	115	88.7	78.7	56.2	42.3	38.8	31.3	26.3	21.7	11.1
1.65V	326	278	233	154	133	113	87.3	76.7	54.8	41.9	37.9	30.9	25.9	21.5	11.0
1.70V	301	257	216	144	127	111	86.0	74.0	53.3	41.2	37.5	30.5	25.5	21.1	10.9
1.75V	268	231	198	134	122	110	84.7	71.3	51.6	40.5	36.5	30.0	25.3	20.8	10.7
1.80V	231	205	184	125	117	107	82.0	67.3	50.0	39.0	35.6	28.9	24.7	20.0	10.3
1.85V	202	180	162	112	104	97.0	80.7	62.8	47.5	38.6	34.4	28.5	24.1	19.8	10.0

Constant Power Discharge Characteristics Unit: W/cell (25°C ,77°F)

FV/Time	5min	10min	15min	30min	45min	1h	1.5h	2h	3h	4h	5h	6h	8h	10h	20h
1.60V	593	508	441	299	257	217	166	148	106	80.7	73.7	59.7	50.6	42.0	21.8
1.65V	542	469	416	281	247	213	164	144	103	79.5	72.7	59.1	49.8	41.6	21.5
1.70V	519	434	388	263	236	209	162	139	100	78.1	71.3	58.2	49.0	41.1	21.3
1.75V	468	393	362	245	226	207	159	134	97.1	76.7	69.3	57.3	48.5	40.3	21.0
1.80V	414	354	341	231	216	202	154	127	94.0	74.9	67.6	55.1	47.5	38.9	20.2
1.85V	362	313	303	206	195	183	152	118	89.2	72.7	65.4	54.5	46.2	38.6	20.1