

### General Features

- ▶ Nanosilica colloidal electrolyte and high tin positive plate alloy design to enhance battery performance
- ▶ Relatively rich electrolyte, high temperature and low temperature performance is superior
- ▶ Long cycle life, excellent deep cycle discharge ability
- ▶ Excellent charge acceptance ability
- ▶ Precision sealing technology
- ▶ Long life



**Dimension: 330(L) × 171(W) × 216(H) × 219(TH)**

**Unit: mm**

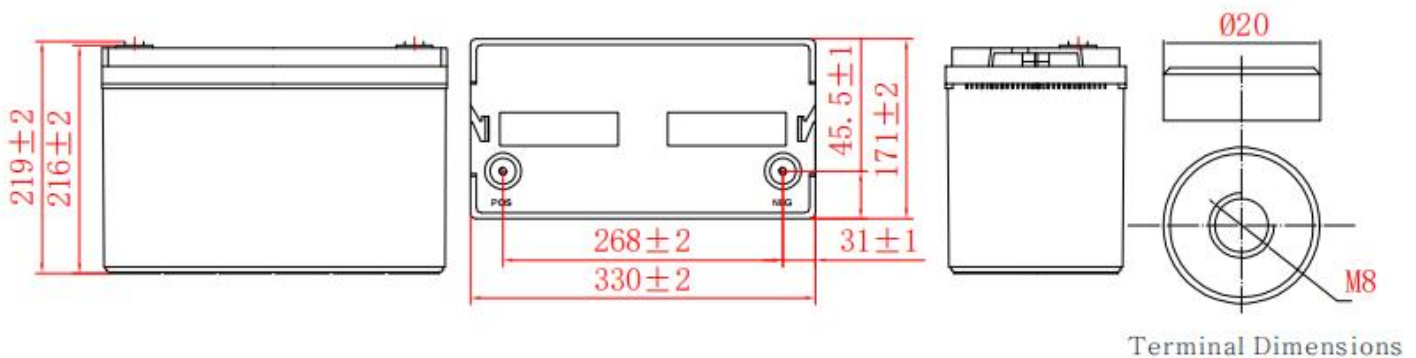

Specification	
Nominal Voltage	12V
Nominal Capacity	100Ah
Design life	10 years
Terminal	M8
Approx. Weight	Approx 32.0kg (70.5lbs)
Container Material	ABS
short-circuit current	2400A
Internal resistance(Full charged at 25°C: )	5.0 mΩ
Self discharge	3% of capacity declined per month at 25°C
Operating Temperature	
Discharge:	-20 ~50°C(-4~ 122°F)
Charge :	-20 ~50°C(-4~ 122°F)
Storage:	-20 ~50°C(-4~ 122°F)
Charge Method(25 °C)	
Charge current:	Max. 27.5A;Recom.11A
Float charge:13.5-13.8V	recom.13.8V(-18mV/ °C)
Equalize charge:13.8-14.1V	recom.14.1V(-24mV/ °C)
Cycle charge:14.4-15.0V	recom.14.7V(-30mV/ °C)

### Standards

Executive standard YD/T 799-2010

### Applications

- ▶ UPS/EPS
- ▶ Power systems
- ▶ Telecommunications system
- ▶ Emergency lighting, Auto control system
- ▶ Solar/wind generating storage cyclic
- ▶ Other general purpose

### Rated Capacity

20Hour Rate (5.50A to 10.5V)	110.0Ah
3Hour Rate (27.9A to 10.2V)	83.7Ah
1Hour Rate (68.8A to 9.6V)	68.8Ah

### Attain Certificate



### Discharge characteristic

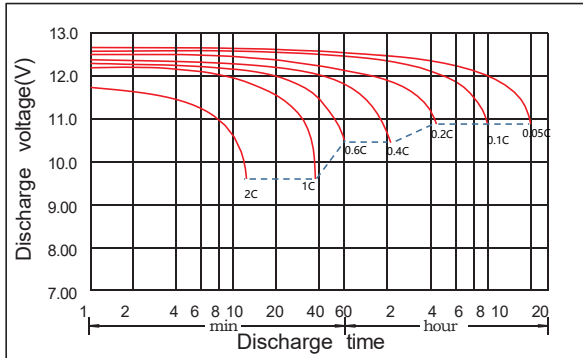

### Charging characteristic

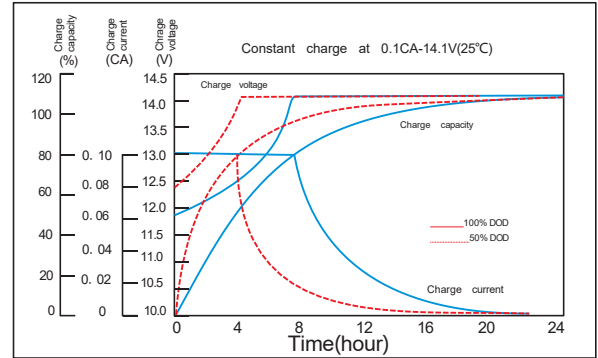

### The effect of temperature on capacity

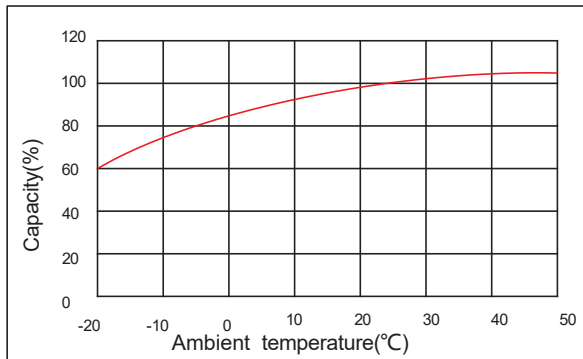

### The effect of discharge depth on cycle life

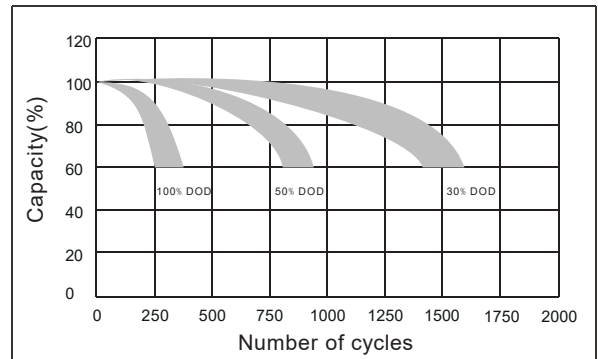

### Constant Current Discharge Characteristics Unit:A (25°C,77°F)

FV/Time	5min	10min	15min	30min	45min	1h	1.5h	2h	3h	4h	5h	6h	8h	10h	20h
1.60V	306	239	193	118	84.4	68.8	43.2	39.5	28.6	20.8	19.2	15.3	12.7	10.6	5.58
1.65V	301	238	188	116	83.9	68.4	42.8	39.3	28.3	20.5	19.0	15.1	12.6	10.5	5.55
1.70V	289	236	184	113	83.3	67.9	42.4	38.9	27.9	20.3	18.8	15.0	12.5	10.4	5.52
1.75V	266	233	178	112	82.1	67.0	42.0	38.3	27.6	20.1	18.6	14.9	12.4	10.3	5.50
1.80V	238	227	166	107	80.0	65.2	41.6	37.6	27.5	19.9	18.1	14.7	12.3	10.2	5.47
1.85V	212	211	147	98.3	74.1	60.4	40.3	35.8	25.9	19.3	17.3	14.3	11.8	9.92	5.38

### Constant Power Discharge Characteristics Unit: W/cell (25°C ,77°F )

FV/Time	5min	10min	15min	30min	45min	1h	1.5h	2h	3h	4h	5h	6h	8h	10h	20h
1.60V	520	405	340	213	155	130	86.3	74.6	54.5	40.9	36.5	30.0	24.5	20.4	11.0
1.65V	512	402	335	211	154	129	85.5	74.4	53.8	40.5	36.3	29.6	24.3	20.3	11.0
1.70V	491	399	331	211	153	128	84.5	74.1	53.5	40.1	36.0	29.3	24.2	20.0	10.9
1.75V	452	396	329	210	152	127	83.7	73.7	53.2	39.7	35.8	29.1	24.0	19.8	10.9
1.80V	404	393	311	205	151	126	82.8	73.5	53.0	39.3	35.4	28.8	23.8	19.6	10.8
1.85V	363	367	278	188	141	118	81.6	70.2	50.4	38.6	33.7	28.3	23.0	19.3	10.7