



## General Features

- ▶ High corrosion resistant performance: Pb-Ca multi-alloy grid
- ▶ High energy density and power density
- ▶ Optimized capability of instant high-current discharging
- ▶ Excellent charge acceptance ability
- ▶ Excellent deep cycle discharge capability
- ▶ Strong high and low temperature performance
- ▶ Precision sealing technology
- ▶ Long life



**Dimension: 295(L) × 178(W) × 404(H) × 407(TH)**

**Unit: mm**

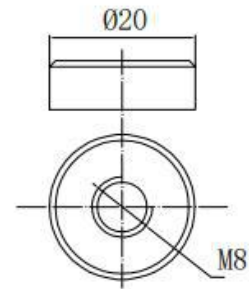
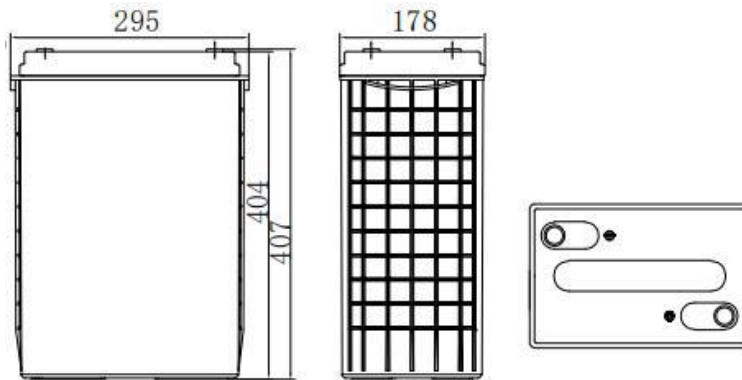

Terminal Dimensions

| Specification                               |   |
|---|---|
| Nominal Voltage                             | 6V  |
| Nominal Capacity                            | 380Ah                                     |
| Design life                                 | 10 years                                  |
| Terminal                                    | M8  |
| Approx. Weight                              | Approx 55.0kg (121.3lbs)                  |
| Container Material                          | ABS                                       |
| short-circuit current                       | 3333A                                     |
| Internal resistance(Full charged at 25°C: ) | 1.8 mΩ                                    |
| Self discharge                              | 3% of capacity declined per month at 25°C |
| Operating Temperature                       |   |
| Discharge:                                  | -20 ~50°C(-4~ 122°F)                      |
| Charge :                                    | -20 ~50°C(-4~ 122°F)                      |
| Storage:                                    | -20 ~50°C(-4~ 122°F)                      |
| Charge Method(25 °C)                        |   |
| Charge current:                             | Max. 76.0A; Recom. 38.0A                  |
| Float charge: 6.75-6.90V                    | recom. 6.90V(-9mV/ °C)                    |
| Equalize charge: 6.90-7.05V                 | recom. 7.05V(-12mV/ °C)                   |
| Cycle charge: 7.20-7.50V                    | recom. 7.20V(-15mV/ °C)                   |

## Standards

Executive standard GB/T 32620.1-2016

## Applications

- ▶ UPS/EPS
- ▶ Power systems
- ▶ Telecommunications system
- ▶ Emergency lighting, Auto control system
- ▶ Solar/wind generating storage cyclic
- ▶ Other general purpose

## Rated Capacity

|                              |         |
|------------------------------|---------|
| 20Hour Rate (19.0A to 5.25V) | 380.0Ah |
| 3Hour Rate (101A to 5.10V)   | 303.0Ah |
| 1Hour Rate (234A to 4.80V)   | 234.0Ah |

## Attain Certificate

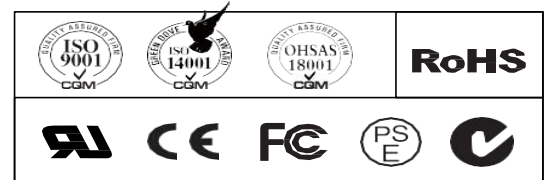

Disclaimer: Manufacturers have the right to self-modify the parameters of the product updates, please keep in touch with manufacturers to obtain the latest information.



## Discharge characteristic

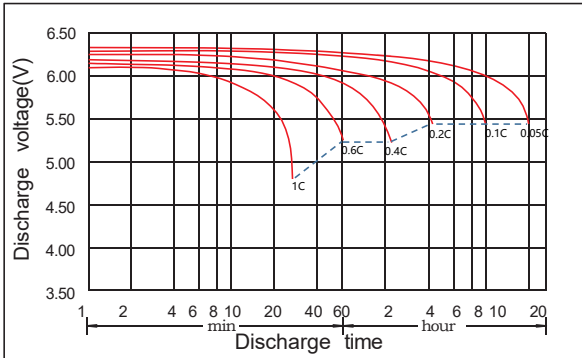

## Charging characteristic

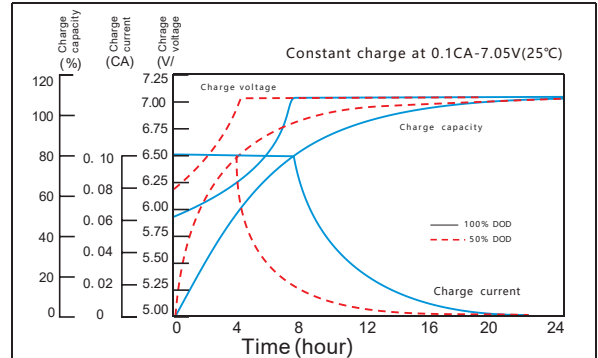

## The effect of temperature on capacity

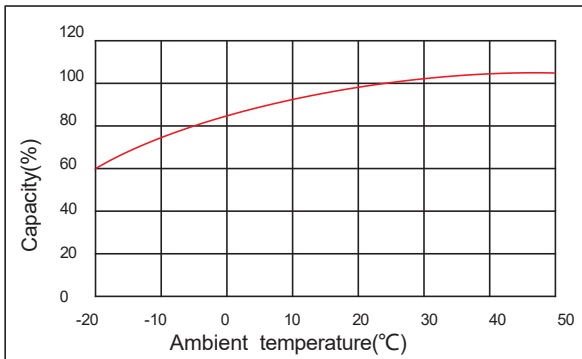

## The effect of temperature on float life

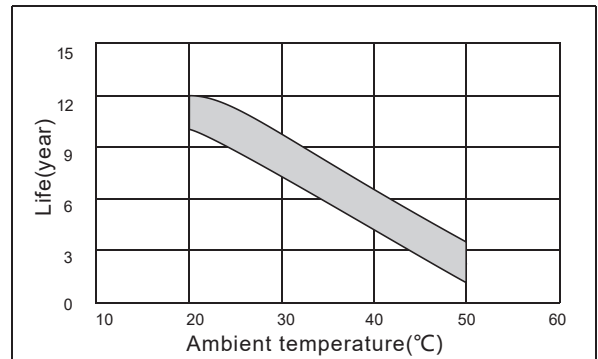

## Constant Current Discharge Characteristics Unit:A (25°C,77°F)

| FV/Time | 5min | 10min | 15min | 30min | 45min | 1h  | 1.5h | 2h  | 3h   | 4h   | 5h   | 6h   | 8h   | 10h  | 20h  |
|---------|------|-------|-------|-------|-------|-----|------|-----|------|------|------|------|------|------|------|
| 1.60V   | 306  | 306   | 306   | 306   | 306   | 234 | 158  | 145 | 104  | 75.2 | 69.7 | 55.8 | 45.8 | 38.6 | 19.8 |
| 1.65V   | 301  | 301   | 301   | 301   | 301   | 233 | 156  | 143 | 103  | 74.4 | 69.1 | 55.1 | 45.4 | 38.3 | 19.6 |
| 1.70V   | 289  | 289   | 289   | 289   | 289   | 231 | 154  | 141 | 101  | 73.7 | 68.4 | 54.6 | 45.0 | 37.8 | 19.3 |
| 1.75V   | 266  | 266   | 266   | 266   | 266   | 228 | 153  | 139 | 100  | 73.1 | 67.7 | 54.1 | 44.7 | 37.5 | 19.0 |
| 1.80V   | 238  | 238   | 238   | 238   | 238   | 222 | 151  | 136 | 99.2 | 72.4 | 65.7 | 53.4 | 44.3 | 37.1 | 18.7 |
| 1.85V   | 212  | 212   | 212   | 212   | 212   | 206 | 146  | 130 | 93.6 | 70.3 | 62.5 | 51.9 | 42.5 | 36.1 | 18.3 |

## Constant Power Discharge Characteristics Unit: W/cell (25°C ,77°F )

| FV/Time | 5min | 10min | 15min | 30min | 45min | 1h  | 1.5h | 2h  | 3h  | 4h  | 5h  | 6h  | 8h   | 10h  | 20h  |
|---------|------|-------|-------|-------|-------|-----|------|-----|-----|-----|-----|-----|------|------|------|
| 1.60V   | 520  | 520   | 520   | 520   | 520   | 446 | 306  | 280 | 201 | 146 | 135 | 109 | 89.1 | 75.2 | 38.9 |
| 1.65V   | 512  | 512   | 512   | 512   | 512   | 444 | 302  | 277 | 200 | 144 | 134 | 108 | 88.6 | 74.6 | 38.3 |
| 1.70V   | 491  | 491   | 491   | 491   | 491   | 441 | 298  | 273 | 196 | 143 | 133 | 106 | 88.0 | 73.7 | 37.8 |
| 1.75V   | 452  | 452   | 452   | 452   | 452   | 435 | 297  | 269 | 194 | 142 | 131 | 105 | 87.3 | 73.2 | 37.2 |
| 1.80V   | 404  | 404   | 404   | 404   | 404   | 423 | 293  | 264 | 192 | 140 | 127 | 104 | 86.4 | 72.3 | 36.7 |
| 1.85V   | 363  | 363   | 363   | 363   | 363   | 395 | 286  | 253 | 183 | 137 | 122 | 101 | 83.3 | 70.7 | 36.0 |