



General Features

- ▶ High corrosion resistant performance: Pb-Ca multi-alloy grid
- ▶ High energy density and power density
- ▶ Optimized capability of instant high-current discharging
- ▶ Excellent charge acceptance ability
- ▶ Excellent deep cycle discharge capability
- ▶ Strong high and low temperature performance
- ▶ Precision sealing technology
- ▶ Long life



Dimension: 295(L) × 178(W) × 345(H) × 348(TH)

Unit: mm

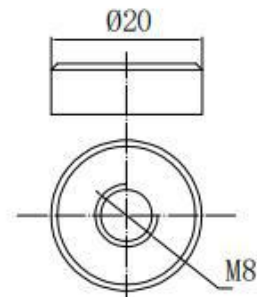
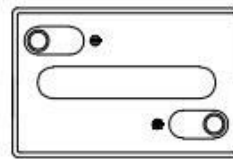
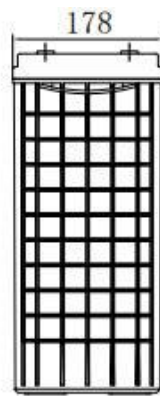
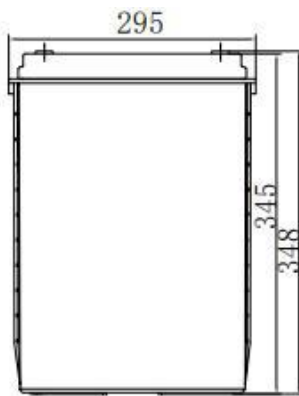

Terminal Dimensions

| Specification | |
|--|---|
| Nominal Voltage | 6V |
| Nominal Capacity | 330Ah |
| Design life | 10 years |
| Terminal | M8 |
| Approx. Weight | Approx. 47.0kg (103.6lbs) |
| Container Material | ABS |
| short-circuit current | 3333A |
| Internal resistance (Full charged at 25°C:) | 1.8 mΩ |
| Self discharge | 3% of capacity declined per month at 25°C |
| Operating Temperature | |
| Discharge: | -20 ~50°C (-4 ~ 122°F) |
| Charge : | -20 ~50°C (-4 ~ 122°F) |
| Storage: | -20 ~50°C (-4 ~ 122°F) |
| Charge Method (25 °C) | |
| Charge current: | Max. 66.0A; Recom. 33.0A |
| Float charge: | 6.75-6.90V recom. 6.90V (-9mV/ °C) |
| Equalize charge: | 6.90-7.05V recom. 7.05V (-12mV/ °C) |
| Cycle charge: | 7.20-7.50V recom. 7.20V (-15mV/ °C) |

Standards

Executive standard GB/T 32620.1-2016

Applications

- ▶ UPS/EPS
- ▶ Power systems
- ▶ Telecommunications system
- ▶ Emergency lighting, Auto control system
- ▶ Solar/wind generating storage cyclic
- ▶ Other general purpose

Rated Capacity

| | |
|------------------------------|---------|
| 20Hour Rate (16.5A to 5.25V) | 330.0Ah |
| 3Hour Rate (87.7A to 5.10V) | 263.1Ah |
| 1Hour Rate (203A to 4.8V) | 203.0Ah |

Attain Certificate





Discharge characteristic

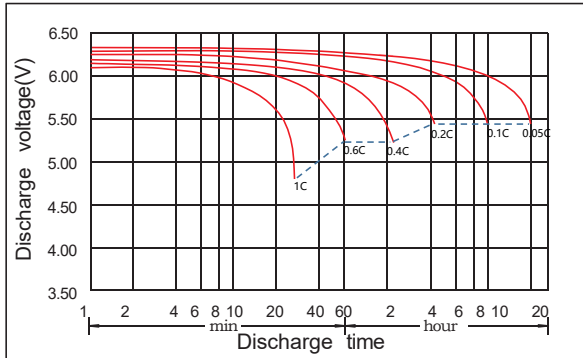

Charging characteristic

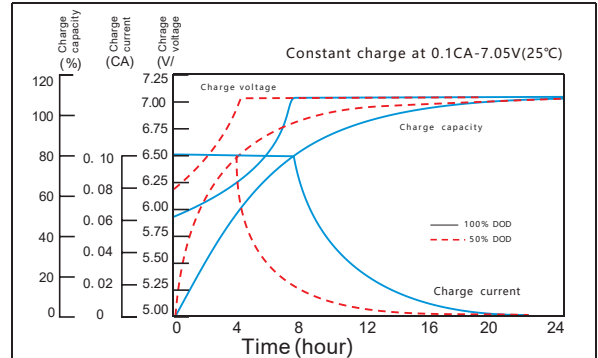

The effect of temperature on capacity

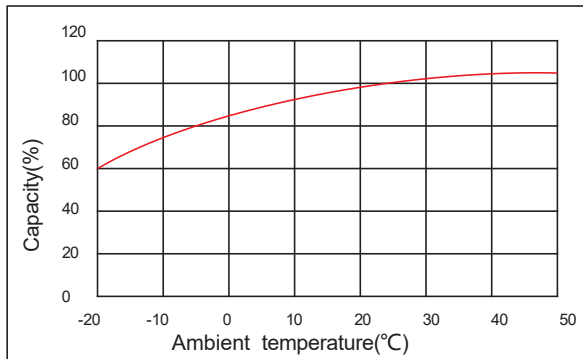

The effect of temperature on float life

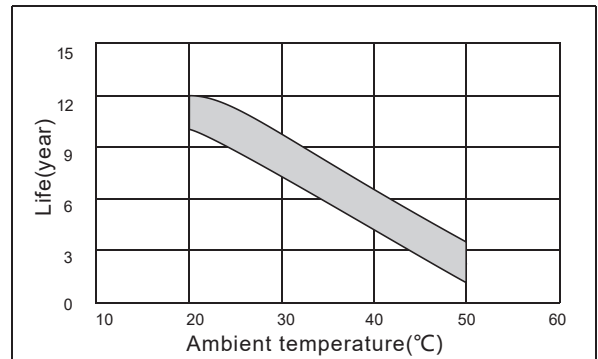

Constant Current Discharge Characteristics Unit:A (25°C,77°F)

| FV/Time | 5min | 10min | 15min | 30min | 45min | 1h | 1.5h | 2h | 3h | 4h | 5h | 6h | 8h | 10h | 20h |
|---------|------|-------|-------|-------|-------|-----|------|-----|------|------|------|------|------|------|------|
| 1.60V | 306 | 306 | 306 | 306 | 256 | 203 | 137 | 126 | 90.1 | 65.3 | 60.5 | 48.3 | 39.8 | 33.5 | 17.2 |
| 1.65V | 301 | 301 | 301 | 301 | 253 | 202 | 135 | 124 | 89.3 | 64.6 | 60.0 | 47.9 | 39.4 | 33.2 | 17.0 |
| 1.70V | 289 | 289 | 289 | 289 | 250 | 200 | 134 | 122 | 87.7 | 64.0 | 59.4 | 47.4 | 39.1 | 32.8 | 16.7 |
| 1.75V | 266 | 266 | 266 | 266 | 248 | 198 | 133 | 121 | 86.9 | 63.5 | 58.8 | 47.0 | 38.8 | 32.6 | 16.5 |
| 1.80V | 238 | 238 | 238 | 238 | 238 | 192 | 131 | 118 | 86.1 | 62.9 | 57.1 | 46.4 | 38.5 | 32.2 | 16.3 |
| 1.85V | 212 | 212 | 212 | 212 | 219 | 179 | 127 | 113 | 81.3 | 61.0 | 54.2 | 45.1 | 36.9 | 31.3 | 15.9 |

Constant Power Discharge Characteristics Unit: W/cell (25°C ,77°F)

| FV/Time | 5min | 10min | 15min | 30min | 45min | 1h | 1.5h | 2h | 3h | 4h | 5h | 6h | 8h | 10h | 20h |
|---------|------|-------|-------|-------|-------|-----|------|-----|-----|-----|------|------|------|------|------|
| 1.60V | 520 | 520 | 520 | 520 | 474 | 352 | 265 | 224 | 157 | 126 | 107 | 92.2 | 70.4 | 62.9 | 35.0 |
| 1.65V | 512 | 512 | 512 | 512 | 468 | 346 | 261 | 220 | 155 | 124 | 105 | 90.6 | 69.1 | 61.8 | 34.3 |
| 1.70V | 491 | 491 | 491 | 491 | 462 | 339 | 256 | 216 | 152 | 121 | 103 | 88.8 | 67.9 | 60.6 | 33.6 |
| 1.75V | 452 | 452 | 452 | 452 | 459 | 332 | 251 | 211 | 149 | 119 | 101 | 87.2 | 66.6 | 59.5 | 33.0 |
| 1.80V | 404 | 404 | 404 | 404 | 441 | 320 | 241 | 204 | 143 | 114 | 97.4 | 83.9 | 64.0 | 57.2 | 31.7 |
| 1.85V | 363 | 363 | 363 | 363 | 407 | 303 | 230 | 195 | 134 | 109 | 91.9 | 79.9 | 60.8 | 54.5 | 30.3 |